

HIGH VELOCITY SPRAY NOZZLE

BRASS



High Velocity spray nozzles are used for fire risks involving thick, viscous flammable oils, such as transformer oils. The high velocity water spray strikes surface of the leaked transformer oil, forming a nonflammable emulsion. Different flow capacities (K factor) and spray angles available.

Brief Description: AAAG High Velocity Water Spray nozzle, made of brass (forged), with 3/4" male threaded inlet (1" threaded inlet option available). Nozzle worm shall be of brass. The nozzle K factors (SI) available include 18, 22, 26, 32, while spray angle can be 75°/80°/90°/100°.

1.0 GENERAL DATA

1.1	Make	AAAG
1.2	Model	HV
1.3	Inlet	1/2" / 3/4" Male threaded (BSP) inlet
1.4	Outlet	Spray nozzle
1.5	Material of Construction	Bronze
1.6	Reference	--

2.0 MATERIAL OF CONSTRUCTION

2.1	Body	Bronze IS:291 Gr. 1
2.2	Worm	Bronze IS:291 Gr. 1

3.0 TESTING AND QUALITY CONTROL

3.1	Dimensional check	See Drawing below
3.2	Operational test	Flow & Angle as per specified K-factor & spray angle
3.3	Documentation	Internal inspection report, supplier's certificates, approved laboratory test certificates

4.0 OPERATIONAL/ TECHNICAL DATA

4.1	Working pressure	3.5 to 12 Kg/cm ²
4.2	Weight (Approx.)	0.2 Kgs.

5.0 FINISH

5.1	Nozzle	Natural finish or Chromium plated
-----	--------	-----------------------------------

6.0 APPROVALS & MARKING

6.1	Approvals	--
6.2	Marking	AAAG/ Year of Mfg./ K-factor/Spray Angle

7.0 WARRANTY

7.1	Warranty & Guarantee	12 Months from the date of supply
-----	----------------------	-----------------------------------

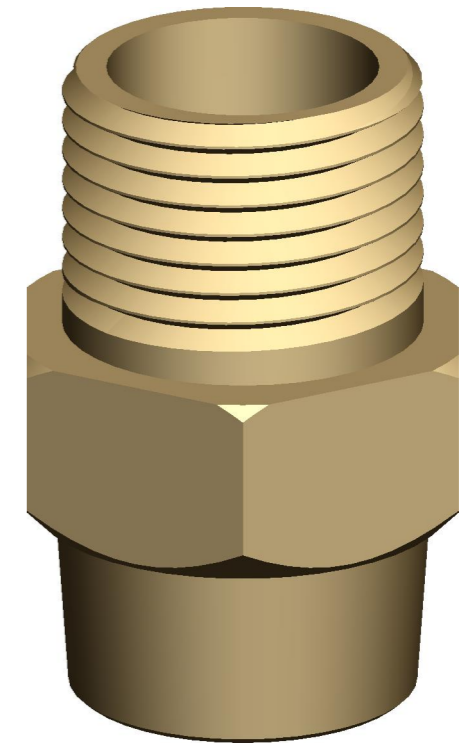
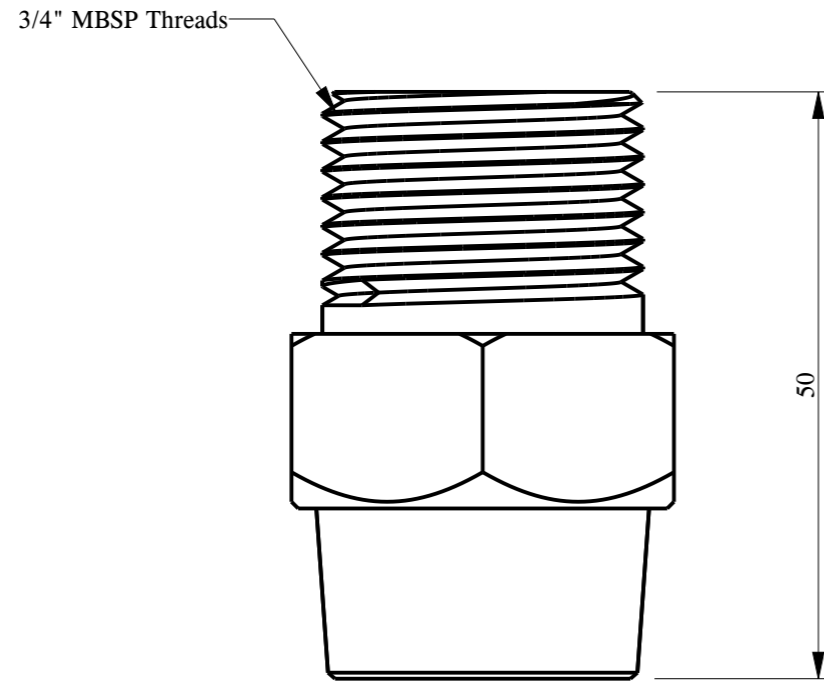

HIGH VELOCITY WATER SPRAY NOZZLE

K-FACTOR	18	22	26	32						
SPRAY ANGLE	75°, 80°, 90°, 100°									
CAPACITY	34 TO 60 LPM @ 3.5 Kgf/Cm2									
MATERIAL	Bronze IS:291 Gr.1									
FINISH	Polished									
WEIGHT	0.2 Kg. Approx									



Shah Bhogilal Jethalal & Bros.

AHMEDABAD

TITLE :

High Velocity Spray Nozzle,
Brass, Conventional Design

SCALE

DRAWING NO:

SHEET

REV.

N.T.S

B291B-12BJ

1 OF 1

0