

## FOAM POURER

### CARBON STEEL, 150 NB SIZE



Foam Pourers are meant to be used with Foam Makers, and ensure that the foam is poured gently onto the roof of the Floating roof tank. Foam Pourers of different designs are available depending upon client requirement, and are matched to the capacity of the Foam makers.

**Brief Description :** AAAG Foam Pourer, made of Carbon Steel, Inlet size 150 NB, suitable for use with matching Foam makers (i.e. 425-940 lpm capacity), Inlet flange as per ANSI 16.5 150 # (or as per request). Foam pourer shall have design suitable for discharging foam gently onto the tank shell.

#### 1.0 GENERAL DATA

1.1	Make	AAAG
1.2	Model	FP150
1.3	Inlet	150 NB Flange (ANSI 16.5 150#)
1.4	Outlet	Foam Delivery Outlet
1.5	Material of Construction	Carbon Steel
1.6	Reference	--

#### 2.0 MATERIAL OF CONSTRUCTION

2.1	Pipes	M.S. ERW Pipe IS:1239 Hot Dip Galvanised
2.2	Inlet Flange	Carbon Steel ANSI 16.5 150lbs RF/ FF
2.3	Outlet Pourer	M.S. Sheet

#### 3.0 TESTING AND QUALITY CONTROL

3.1	Dimensional check	See Drawing below
3.2	Operational test	--
3.3	Documentation	Internal inspection report, supplier's certificates, approved laboratory test certificates

#### 4.0 OPERATIONAL/ TECHNICAL DATA

4.1	Working pressure	3.5 to 10 Kgf/cm <sup>2</sup>
4.2	Weight (Approx.)	--

#### 5.0 FINISH

5.1	Foam Pourer	Hot dip galvanized and Painted (Red colour)
-----	-------------	---

#### 6.0 APPROVALS & MARKING

6.1	Approvals	--
6.2	Marking	AAAG/ Year of Mfg./ Capacity/ Sl. No

#### 7.0 WARRANTY

7.1	Warranty & Guarantee	12 Months from the date of supply
-----	----------------------	-----------------------------------

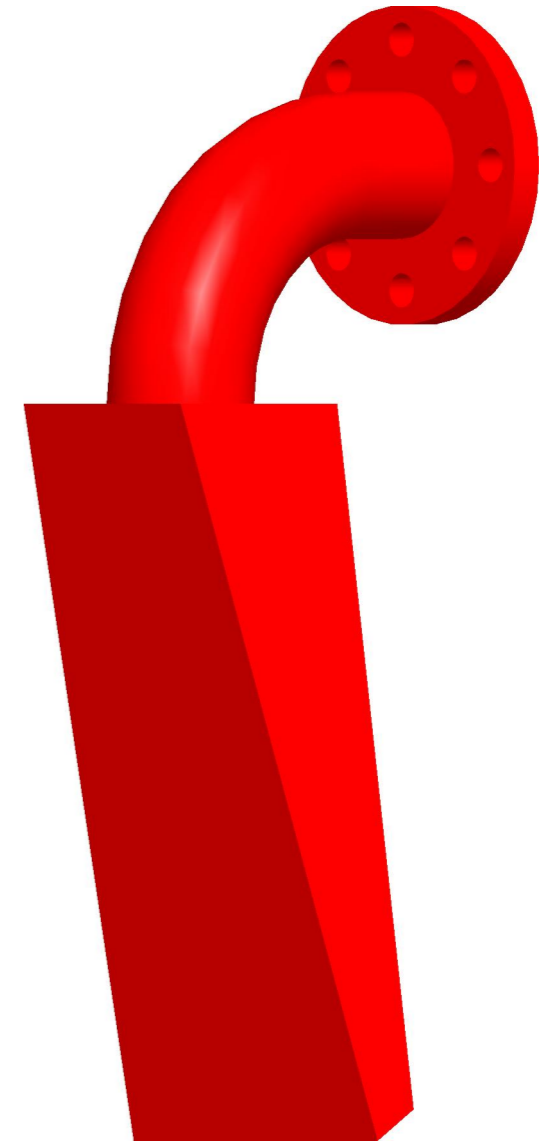
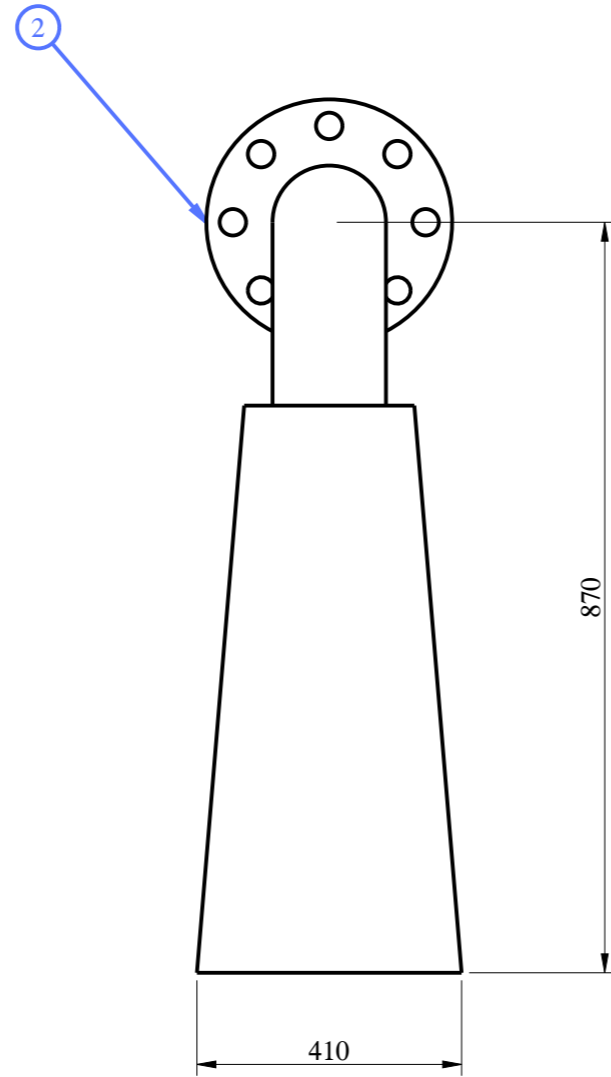
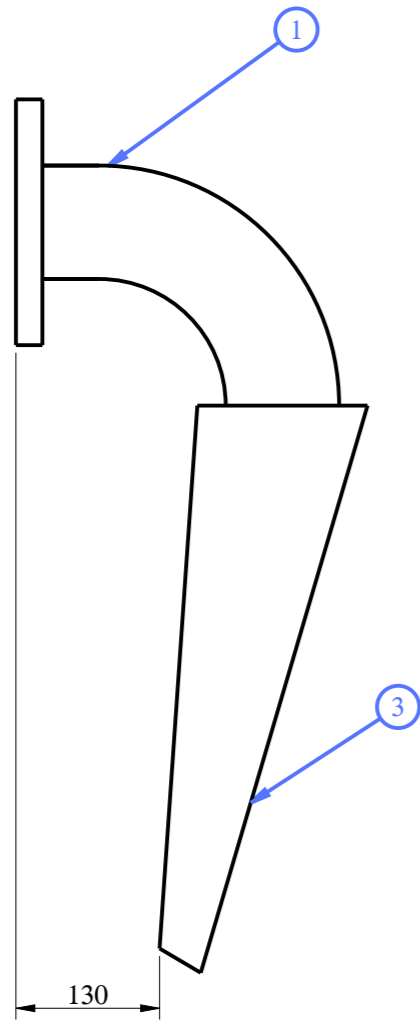

1	Pipe	M.S IS: 1239
2	Inlet Flange	C.S ANSI B 16.5 150lbs RF/FF
3	Outlet Pourer	M.S Sheet
NO.	DESCRIPTION	MATERIAL
PART LIST		



**Shah Bhogilal Jethalal & Bros.**

AHMEDABAD

**TITLE :**

Foam Pourer  
Carbon Steel, 150 NB Size

**SCALE**

**DRAWING NO:**

**SHEET**

**REV.**

N.T.S

M285-150BJ

1 OF 1

0