

STANDPOST MONITOR

CARBON STEEL, 63 mm WATERWAY, ISI MARKED



Standpost monitors are used in fire fighting for applying large quantity of water/foam from a distance onto the risk area. The monitors are normally installed onto stand posts, fitted onto the fire water network, or mounted on trailers/trolleys. Manual swivel joints allow operators to adjust the position of the monitor (or leave it unattended, if required).

Brief Description : AAAG Stand Post type monitor, ISI Marked (IS:8442), nominal waterway size 63mm, flow capacity 1750 lpm at 7 kg/cm² inlet pressure. Monitor shall be constructed of M.S. pipes/ bends, Gunmetal Swivel Joints (manual), have suitable inlet flange and solid jet nozzle of specified capacity. Monitor shall give minimum throw as specified in IS:8442.

1.0 GENERAL DATA

1.1	Make	AAAG
1.2	Model	Stand Post Type Monitor (63 mm Waterway)
1.3	Inlet	Flanged - 75 NB IS:1538/ ANSI B16.5 150#
1.4	Outlet	32 mm (min) bore Solid Jet Nozzle
1.5	Material of Construction	Carbon Steel
1.6	Reference	IS:8442 - Specification for stand post type water monitor

2.0 MATERIAL OF CONSTRUCTION

2.1	Base Flange	Carbon (Mild) Steel IS: 2062 /IS: 2004 (ASTM A 105)
2.2	Water barrel (pipe)	Carbon (Mild) Steel IS1239 Part-1 Seamless (ASTM A 106 Gr. B)
2.3	Swivel Joint	GM/ SS IS: 318 LTB-2/ IS: 3444 Gr. 1
2.4	Bends	Carbon (Mild) Steel IS: 4310 (ASTM A 105)
2.5	Handle	Carbon (Mild) Steel IS: 1732(2062)
2.6	Nozzle	Alu. IS: 617/ Gunmetal IS: 318 LTB-2/ SS304/316 (IS: 3444 Gr. I/IV)

3.0 TESTING AND QUALITY CONTROL

3.1	Dimensional check	As per IS:8442 (See drawing below)
3.2	Hydrostatic Pressure Test	25 kgf/cm ² for 2.5 minutes (Monitor only)
3.3	Performance Requirements	<u>Flow test with monitor at 30° elevation, in still wind conditions</u> Flow 1750 lpm (min) at 7 kg/cm ² , Range 53 Mtrs (min)
3.4	Documentation	Internal inspection report, supplier's certificates, approved laboratory test certificates

4.0 OPERATIONAL/ TECHNICAL DATA

4.1	Working pressure	5 to 14 Kg/cm ²
4.2	Manouverability	+90°/ -45° in vertical plane, 360° in horizontal plane
4.3	Weight (approx.)	---

5.0 FINISH

5.1	Body	Hot Dip Galvanised, painted Fire Red Color IS: 5 Shade No 536
5.2	Handle	Painted Black Paint
5.3	Swivel Joints & Nozzle	Polished

6.0 APPROVALS & MARKING

6.1	Approvals	--
6.2	Marking on Nozzle	Model/ Capacity/ Year of Mfg./ Sl. No

7.0 WARRANTY

7.1	Warranty & Guarantee	12 Months from the date of supply
-----	----------------------	-----------------------------------

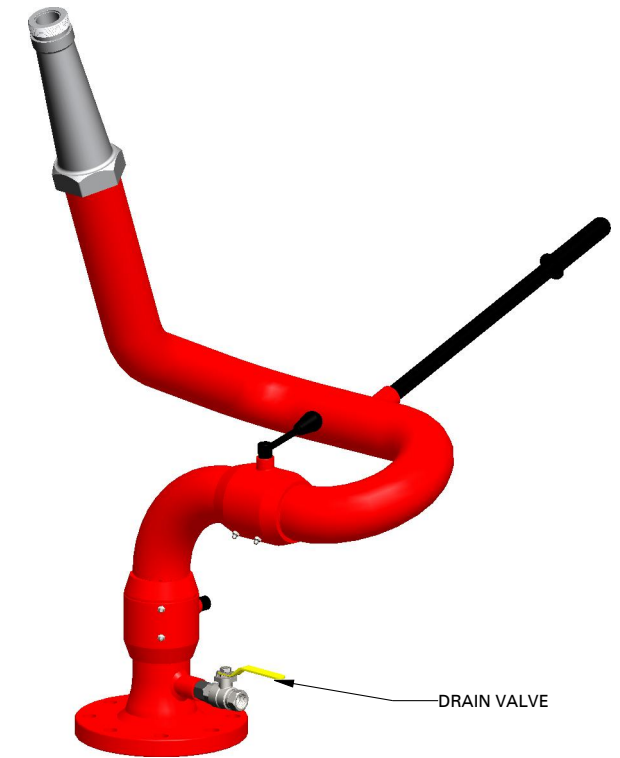
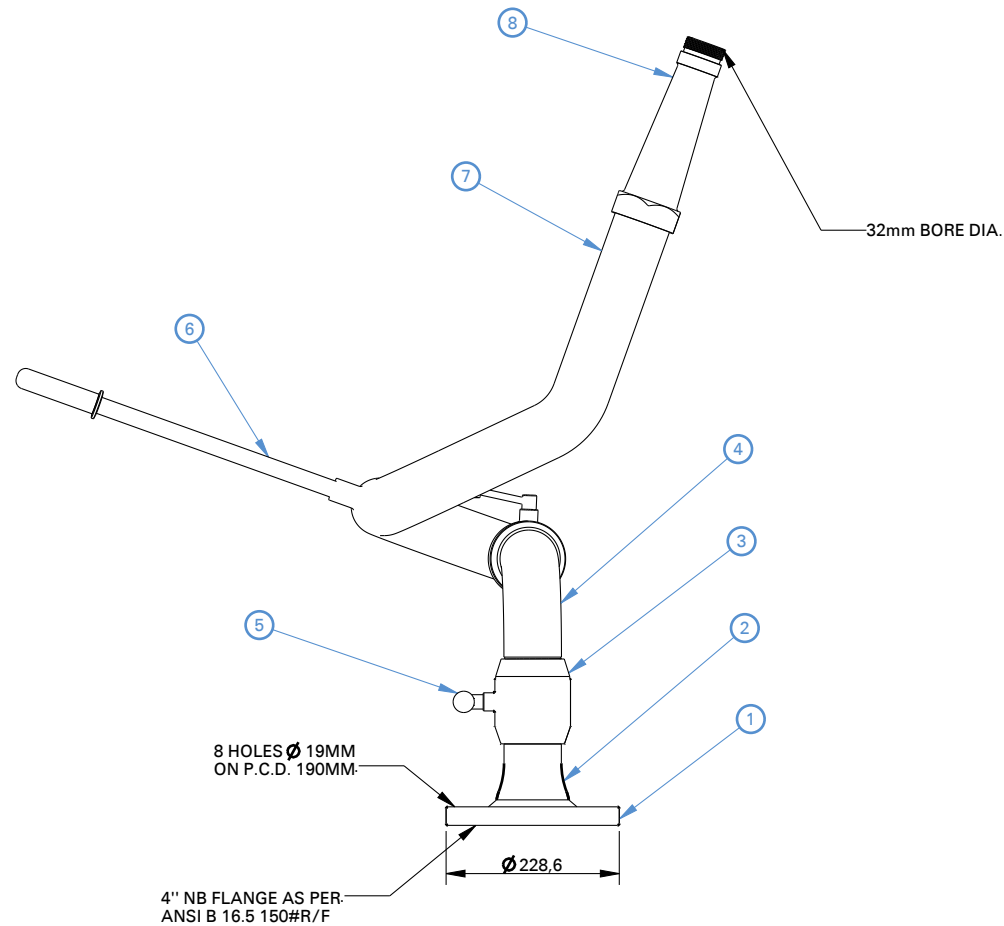

NOTES:

01. **ANTI CORROSIVE TREATMENT & PAINTING:**
M.S. COMPONENTS ARE HOT DIP GALVANISED TO 0.012mm. AND EXTERNAL PAINTING WITH 2 COATS OF FIRE RED COLOUR AS PER IS:5 SHADE NO.536.
02. **PERFORMANCE TEST: DISCHARGE CAPACITY:**
1750 LPM.AT A PRESSURE OF 7KGF/CM2. 55MTR. (WATER) HORIZONTALLY AT 30° TRAJECTORY IN STILL WIND CONDITION.
03. **ROTATION :**
360° IN EITHER DIRECTION IN THE HORIZONTAL PLANE & 125° IN THE VERTICAL PLANE (+80°,- 45°) WITH SEPERATE LOCKING ARRANGEMENT.
04. **HYDROSTATIC PRESSURE TEST :**
23 KGF/CM2.(FOR 5 MINUTES) - WITHOUT NOZZLE

1	FLANGE	M.S. IS:2062
2	REDUCER (4"X2.5")	IS:1239,PART-2
3	SWIVEL JOINT	G.M. IS:318,LTB-2
4	BENDS	M.S. IS:4310
5	LEVER LOCK	BRASS IS:291
6	HANDLE	M.S. IS:1732(2062)
7	WATER BARREL	IS:1239,PART-1
8	NOZZLE	ALU. IS:617
NO.	DESCRIPTION	MATERIAL
PART LIST		



Shah Bhogilal Jethalal & Bros.

AHMEDABAD

TITLE :

Monitor, 63 mm Waterway, Manual Swivel,
Carbon Steel, ISI Marked

SCALE	DRAWING NO:	SHEET	REV.
N.T.S	M195-63IS	1 OF 1	0