

# MULTI-EDGE FIREMAN AXE

CARBON STEEL (FORGED), AS PER IS:5505



The Multi-Edge Fireman Axe is a multipurpose Fire service tool, carried by Firemen for firefighting and rescue purpose. The Axe can be used for breaking locks, piercing doors, cutting wood, metal sheets and similar applications. The axe has an insulated handle, and hence can be safely used on live electrical wires.

**Brief Description :** AAAG Multi-edge Fireman Axe, made of Forged Steel (hardened), and having insulated rubber handle, for Fire service use. Axe has a serrated edge for piercing wooden doors/windows.

## 1.0 GENERAL DATA

1.1	Make	AAAG
1.2	Model	FA Multi-Edge
1.3	Size	--
1.4	Reference Standard	IS:5505

## 2.0 MATERIAL OF CONSTRUCTION

2.1	Axe Head	Carbon Steel (forged)
2.2	Handle	Rubber Moulded (steel)

## 3.0 TESTING AND QUALITY CONTROL

3.1	Dimensional check	As per IS: 5505 (See drawing below)
3.2	Performance Test	As per IS: 5505
3.2	Documentation	Internal inspection report, supplier's certificates, approved laboratory test certificates

## 4.0 OPERATIONAL/ TECHNICAL DATA

4.1	Length (approx.)	0.4 Mtrs
4.2	Weight (approx.)	3.5 kgs

## 5.0 FINISH

5.1	Axe Head	Chromium Plated
5.2	Handle	Rubber Moulded

## 6.0 APPROVALS & MARKING

6.1	Approvals	--
6.2	Marking	AAAG/ Year of Mfg./SI No

## 7.0 WARRANTY

7.1	Warranty & Guarantee	12 Months from the date of supply
-----	----------------------	-----------------------------------

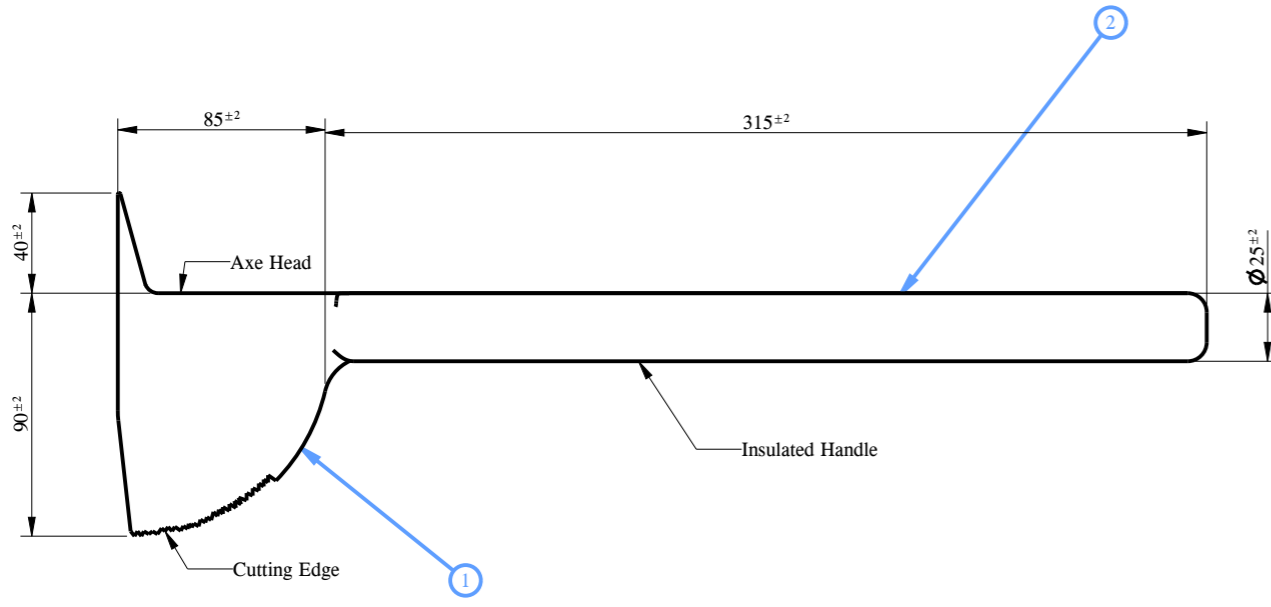

1	Axe Head	Forged Steel
2	Handle	Vulcanized Rubber
NO.	DESCRIPTION	MATERIAL
PART LIST		

**AAAG** SINCE 1933 **Shah Bhogilal Jethalal & Bros.**  
AHMEDABAD

TITLE : Fireman Axe , Multi-Edge, Carbon Steel (Hardened), Conventional Design

SCALE	DRAWING NO:	SHEET	REV.
N.T.S	M206-00BJ	1 OF 1	0